

# Principles of Redistricting

Knox County Board of Education  
Redistricting Committee

March 29, 2011

# Principles of Redistricting

- Redistricting datasets
- Redistricting terminology and requirements
- Redistricting plans and plan evaluation

# MPC Role Redistricting Process

- Lend assistance to the redistricting process by:
  - Providing accurate and objective data
  - Providing tools to support the decision-making process
- MPC does not seek to have any role in evaluating plan alternatives or in the outcome of process

# Redistricting Data Sources

# Census Data Sources

- Public Law 94-171 specifies that within 1 year of Census Day (decennial census), the Census Bureau must send each state the data it will need to redraw districts
- Census Bureau's *Redistricting Data* are specified for use in the redistricting of federal and state legislative districts
- City of Knoxville Charter specifies latest federal census data as well

“Districts shall be reapportioned every ten (10) years based upon the most recent federal census ”

# 2010 Census Results

Year	Population
2000	382,032
2010	432,226
Change	50,194 (13.14%)

# Census Geographic Datasets

- The smallest level at which population data are available from the Census Bureau is the census “block”
- Census block characteristics
  - Generally small in urban areas, larger in rural
  - Bounded by physical features and, in some cases, political subdivisions such as corporate limits

# Census Geographic Datasets

- Block data contain counts of population as well as age, race and ethnic makeup
- Total Population is used for redistricting

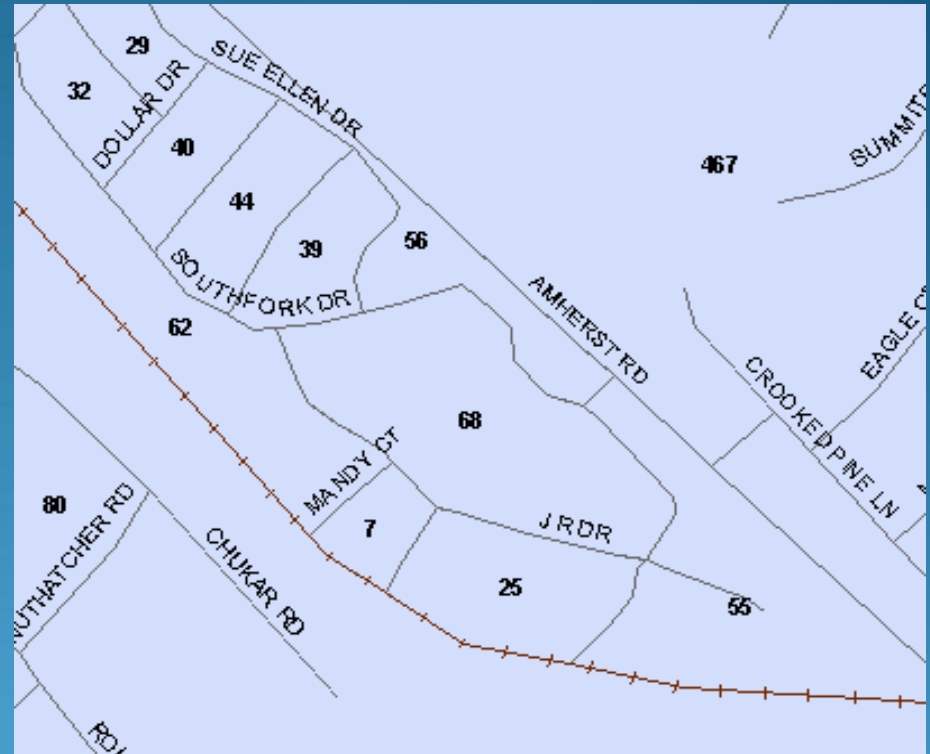

Amherst Ridge Mobile Home Park  
2000 Census Block Population



# Census Geographic Datasets

- Census blocks can be aggregated into larger geographic areas, such as wards or precincts
- Population and demographic summaries within precincts can be generated

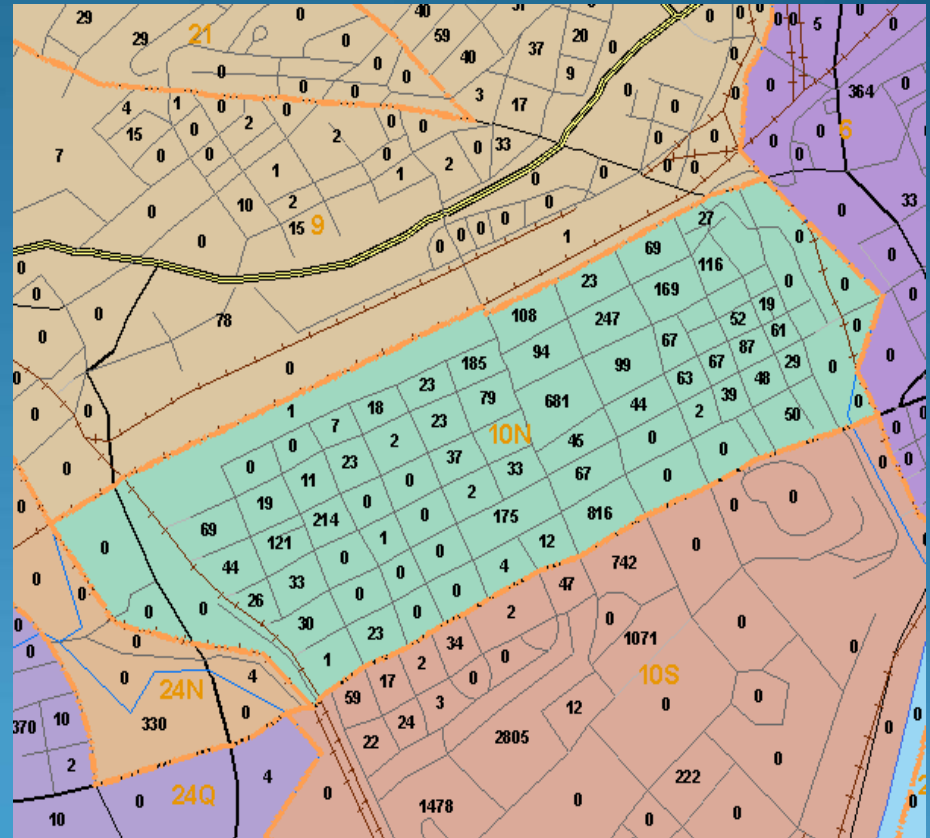

2000 Census Block Population with Voting Precincts

# Redistricting Terminology and Requirements

# One Person, One Vote Standard

- Equal Population
- Operationalizing this principal
  - Ideal Population
  - Absolute and Relative Deviation
  - Overall Range

# Ideal Population

- Target population for each district within legislative body's boundary
- Theoretical Principal
  - Impossible to obtain equal population within each legislative district

# Ideal Population

- Formula:

$$\text{Ideal Population} = \frac{\text{Total Population}}{\text{Number of Districts}}$$

- Knox County Board of Education

2000: 382,032 / 6 Districts = 42,448

2010: 432,226 / 6 Districts = 48,025

- 5,557 person increase per district

# Deviation

- Absolute Deviation
  - Difference between a district's actual population and the district's ideal population
- Relative Deviation
  - Absolute Deviation expressed as a percentage

# Deviation

- Example:
  - Ideal population: 10,000
  - District population: 9,000
  - Absolute Deviation:

$$9,000 - 10,000 = -1000$$

(District population - Ideal Population)

- Relative Deviation:

$$-1,000 / 10,000 = -10\%$$

(Absolute Deviation / Ideal Population)

# Overall Range

- Difference between the districts with the highest and lowest relative deviation
- 10 Percent Rule:
  - Generally accepted standard is that overall range should not exceed 10 percent
  - Redistricting Plans can exceed 10 percent, but officials should prepare a defense



# Overall Range

- Example

- Total Population: 20,000
- Ideal Population: 10,000
- 2 Legislative Districts:
  - District 1 Population: 9,000 (-10%)
  - District 2 Population: 11,000 (10%)

- Overall Range

$$10\% - -10\% = 20\%$$

(Max. Deviation - Min. Deviation = Range)

# Other Considerations

- Compactness and Contiguity

“Districts shall be reasonably compact and contiguous and shall not overlap”

TCA 5-1-111, Section E

- Minority Representation and the Voting Right Act

# Redistricting Plan Development

# Redistricting Plans

- Do we have to reapportion?
  - A legislative body is required to reapportion if it is determined that it no longer meets the standard of equal representation
- When is reapportioning permitted?
  - Change to number of districts or representatives
  - Population change requires it based on latest decennial census

# Redistricting Plans

- Redistricting involves moving census blocks between districts to achieve equal representation
  - 2009 County Commission Process Moved whole precincts/wards; no precincts were split

# Redistricting Plans

- Finite number of district configurations probably exists
  - Don't know what that number is; computers can't just tell us
  - Multiple plans that could be generated meeting the overall range requirements
- When a 10% overall range has been achieved, proceed with evaluating the plan

# Redistricting Data and Software

- Using ESRI's *ArcGIS* software
  - Software upon which City, County, and MPC GIS functions are standardized
  - Districting Extension available free of charge from ESRI

# Plan Evaluation

- MPC role limited to plan validation, not evaluation
- Two means of evaluating a redistricting plan's merit
  1. Objective Evaluations – Data
  2. Subjective Evaluations – Community Values



# Knox County Commission Redistricting



## Redistricting Plan #3A

- Knox County Wards/Precincts
- Wards/Precincts Moved

### Wards/Precincts Key:

- 06 - Green Elem
- 09 - Moses Center
- 10N - Ft Sanders Elem
- 10S - University Center
- 11 - Central United Methodist
- 12 - Eastport Elem
- 13 - Fair Garden Comm Ctr
- 14E - Austin-East High
- 14M - Walter P Taylor Ctr
- 15 - John T O'Conner Ctr
- 16N - Larry Cox Sr Ctr
- 16S - Belle Morris Elem
- 17 - Christenberry Comm Ctr
- 18 - Lincoln Park Elem
- 19 - SOAR Ministries Youth Ctr
- 20 - Beaumont Elem
- 23N - Bible Church of God
- 23S - Westview Elem
- 24N - Pellissippi State Tech
- 30 - Sarah M Greene Elem
- 33 - Richard Yoakley / Alice Bell
- 34 - Fountain City Library
- 37 - Inskip Elem
- 38 - Inskip Elem
- 39 - Inskip Rec Ctr
- 40 - Norwood Elem
- 41 - Norwood Library
- 42 - Pleasant Ridge Elem
- 43 - West Haven Elem
- 50N - West High
- 50S - West High

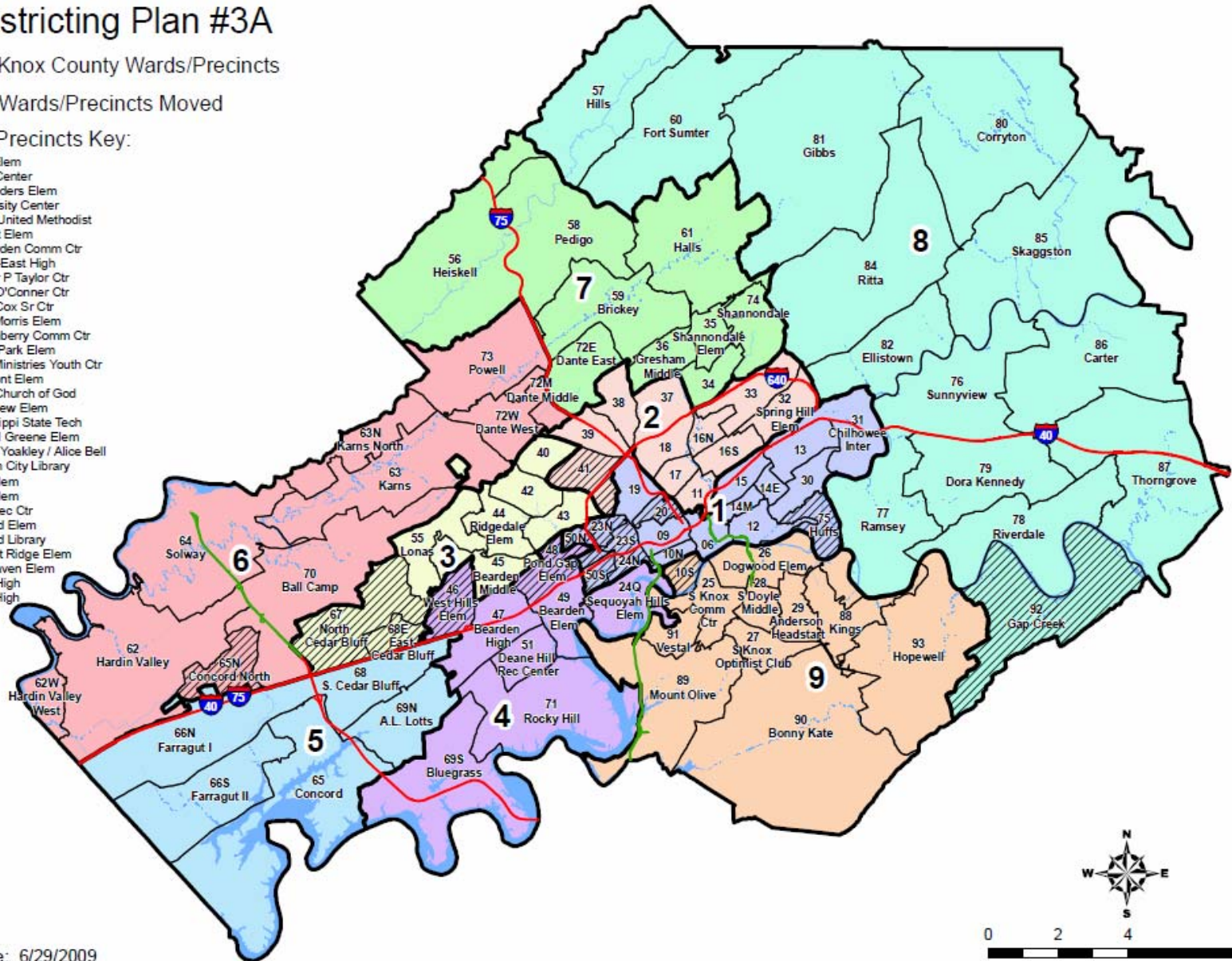

# Redistricting Plan 3A Statistics

Ideal Population per District: 42,448

District	Total Population	Absolute Deviation	Relative Deviation	White		Black		Other		Total Minority	# Voters Moved	Incumbents			
1	42,655	207	0.49%	21,214	49.73%	19,128	44.84%	2,313	5.42%	21,441	50.27%	6895	2		
2	42,736	288	0.68%	37,406	87.53%	3,707	8.67%	1,623	3.80%	5,330	12.47%	3408	2		
3	41,749	-699	-1.65%	37,075	88.80%	3,037	7.27%	1,637	3.92%	4,674	11.20%	16170	3		
4	44,622	2,174	5.12%	41,351	92.67%	1,567	3.51%	1,704	3.82%	3,271	7.33%	4696	2		
5	42,659	211	0.50%	39,932	93.61%	998	2.34%	1,729	4.05%	2,727	6.39%	18519	2		
6	42,024	-424	-1.00%	40,171	95.59%	896	2.13%	957	2.28%	1,853	4.41%	0	2		
7	41,551	-897	-2.11%	40,195	96.74%	623	1.50%	733	1.76%	1,356	3.26%	0	2		
8	41,869	-579	-1.36%	40,217	96.05%	1,086	2.59%	566	1.35%	1,652	3.95%	0	2		
9	42,167	-281	-0.66%	39,010	92.51%	1,945	4.61%	1,212	2.87%	3,157	7.49%	2477	2		
				382,032		07.23	336,571	88.10%	32,987	8.63%	12,474	3.27%	45,461	11.90%	52,165

District	Hispanic		Knoxville Population	Knox Cnty Population	Farragut Population	2006 Est. Population	Registered Voters	Democratic Voters	Republican Voters	
1	699	1.64%	42,647	8	0	41,312	24,888	4,900	1,314	
2	645	1.51%	42,732	4	0	43,967	24,797	4,720	3,256	
3	660	1.58%	20,569	21,180	0	42,954	27,266	4,080	5,013	
4	741	1.66%	28,752	15,870	0	47,231	32,999	5,587	8,190	
5	557	1.31%	1,114	23,827	17,718	50,395	38,658	4,622	9,485	
6	367	0.87%	292	41,732	0	50,529	33,955	4,064	7,842	
7	365	0.88%	11,662	29,889	0	46,673	29,765	3,871	7,219	
8	282	0.67%	106	41,763	0	45,961	26,666	3,351	6,541	
9	487	1.15%	26,016	16,151	0	42,950	25,909	3,399	4,400	
		4,803	1.26%	173,890	190,424	17,718	411,972	264,903	38,594	53,260

# Plan Evaluation

- All plans will meet the basic requirements of overall range, compactness, contiguity and no overlap
- Subjective Compactness Criteria
  - “The ability of citizens to relate to each other and their representatives”
- Objective Compactness Criteria

**2000-2009**  
Commission  
District 1

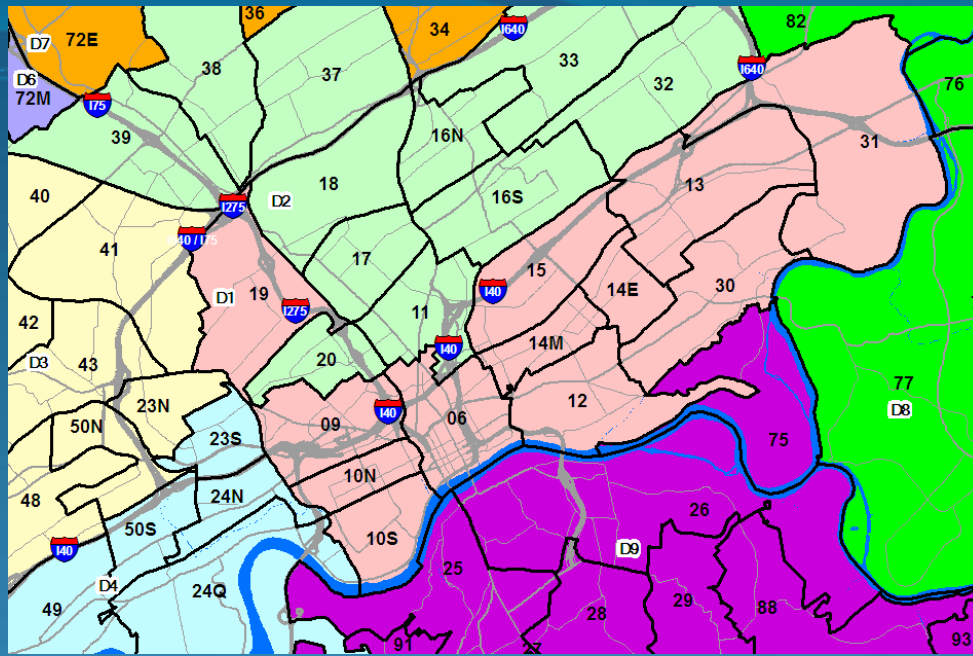

**Compactness:**  
0.0151

**Current**  
(Plan 3A)  
Commission  
District 1

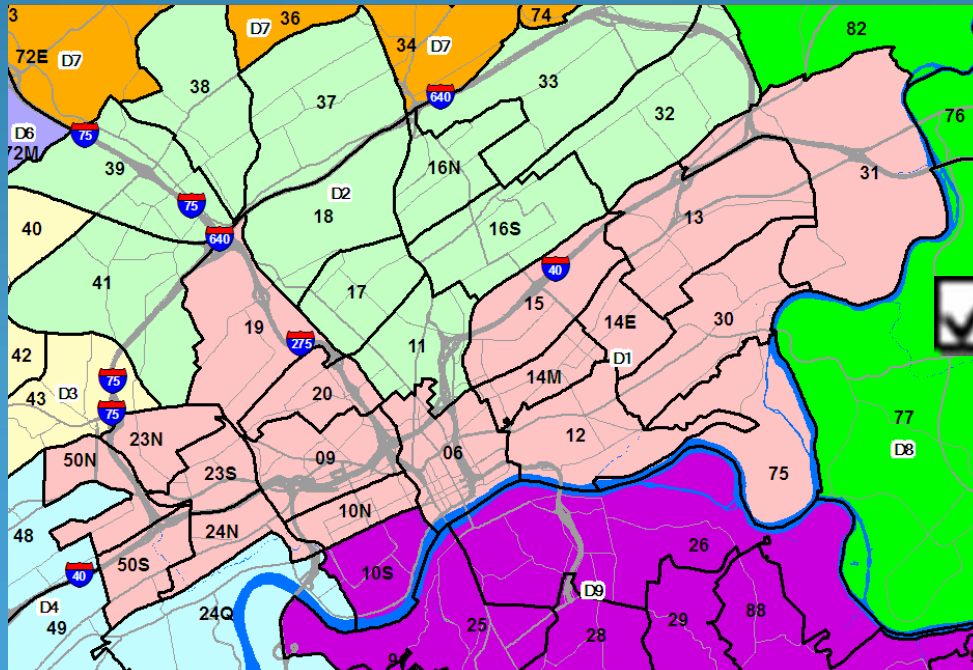

**Compactness:**  
0.0182

**2000-2009  
Commission  
Districts**

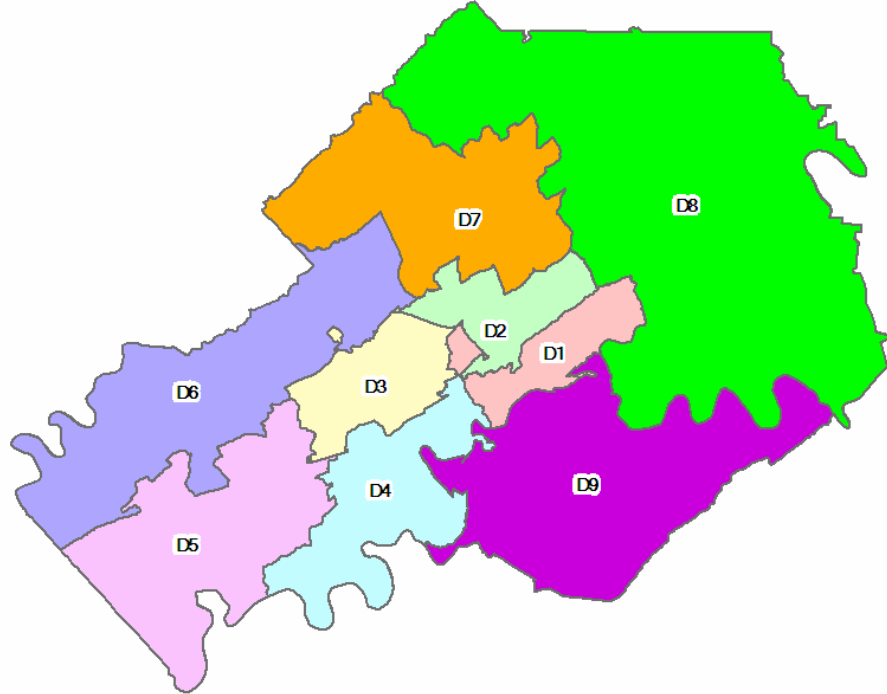

**Compactness:  
46,994**

**Current  
(Plan 3A)  
Commission  
Districts**

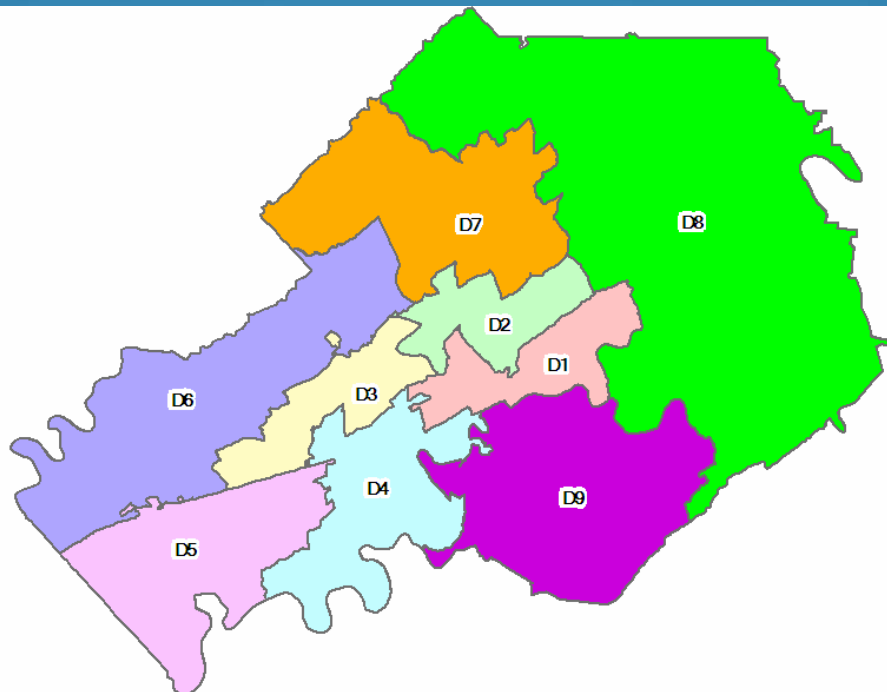

**Compactness:  
47,876**

# 2010 District-Level Population Totals

# Preliminary 2010 Results

2010 Knox County Population: 432,226  
 Preliminary 2010 School Board Ideal Population: 48,025

Board District	Total Population	Absolute Deviation	Relative Deviation
1 - Deathridge	43,712	-4,313	-8.98%
2 - Kincannon	43,275	-4,750	-9.89%
3 - Buttry	45,229	-2,796	-5.82%
4 - Fugate	44,858	-3,167	-6.59%
5 - Carson	52,533	4,508	9.39%
6 - Deakins	55,947	7,922	16.50%
7 - Sepesi	51,785	3,760	7.83%
8 - McMillan	49,394	1,369	2.85%
9 - Trainor	42,217	-5,808	-12.09%
Split Blocks <sup>1</sup>	3,276	N/A	N/A

**Total**                      **432,226**    **Overall Range:**                      **28.59%**

Compiled by: Knoxville-Knox County Metropolitan Planning Commission  
 Source: Census Blocks, P.L. 94-171 Redistricting Dataset, US Bureau of the Census, 2010  
 Notes:

<sup>1</sup>Census blocks represent the smallest geography at which population data is available. Because several census blocks are split by the current Knox County School Board Districts, assignment to a district was not possible and these blocks were not included in the deviation and range determinations.





# Preliminary 2010 Results

2010 Knox County Population: 432,226  
 Preliminary 2010 School Board Ideal Population: 48,025

Board District	Total Population	Absolute Deviation	Relative Deviation
1 - Deathridge	43,712	-4,313	-8.98%
2 - Kincannon	43,489	-4,536	-9.45%
3 - Buttry	45,229	-2,796	-5.82%
4 - Fugate	45,518	-2,507	-5.22%
5 - Carson	54,902	6,877	14.32%
6 - Deakins	55,947	7,922	16.50%
7 - Sepesi	51,818	3,793	7.90%
8 - McMillan	49,394	1,369	2.85%
9 - Trainor	42,217	-5,808	-12.09%

**Total**                      **432,226**      **Overall Range:**                      **28.59%**

Compiled by: Knoxville-Knox County Metropolitan Planning Commission  
 Source: Census Blocks, P.L. 94-171 Redistricting Dataset, US Bureau of the Census, 2010  
 Notes:

<sup>1</sup>Census blocks represent the smallest geography at which population data is available. Because several census blocks are split by the current Knox County School Board Districts, assignment to a district was not initially possible. Using rules of contiguity, precinct lines and residential address points, assignment of split census blocks were made. These assignments resulted in some additional blocks, previously assigned to other districts, to become disconnected from their original district. These blocks were moved with the surrounding blocks to new district in order to restore their contiguity.

# School Board and County Commission District Comparison

# Existing School Board Districts

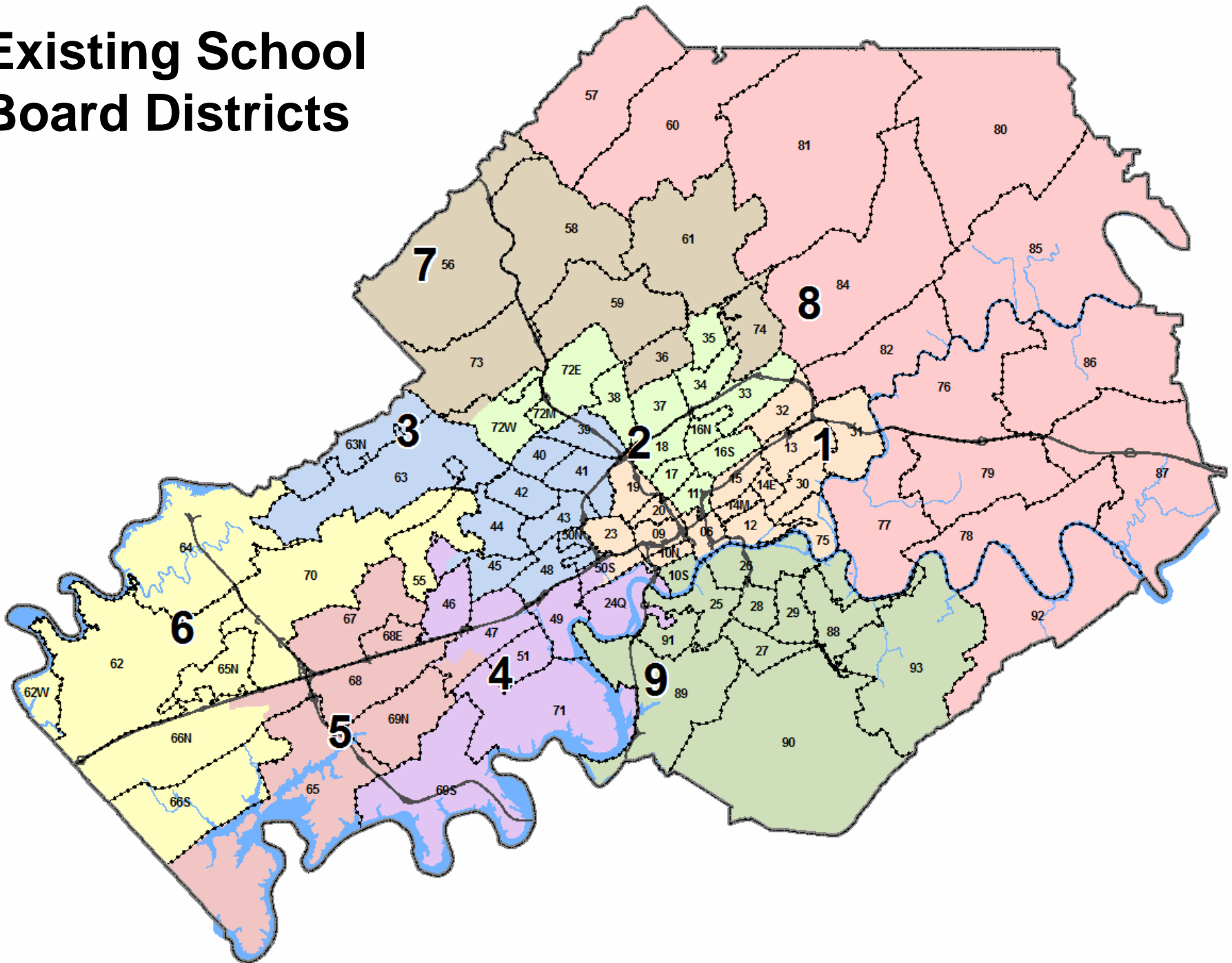

# Existing County Commission Districts

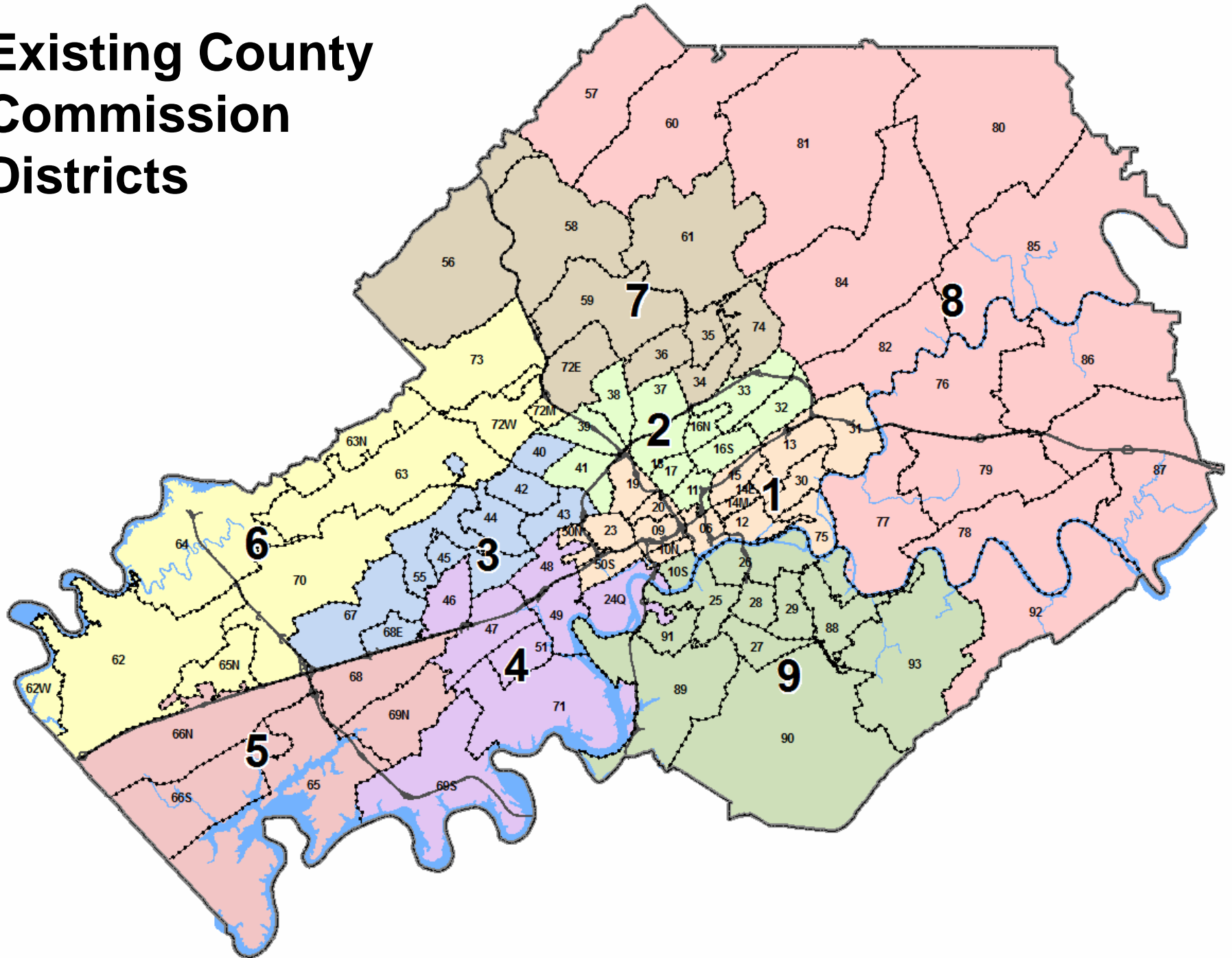

# “Common Ground”

- 327,070 people reside in the same School Board District and County Commission District
- Represents 75.7% of Knox County residents



School Board

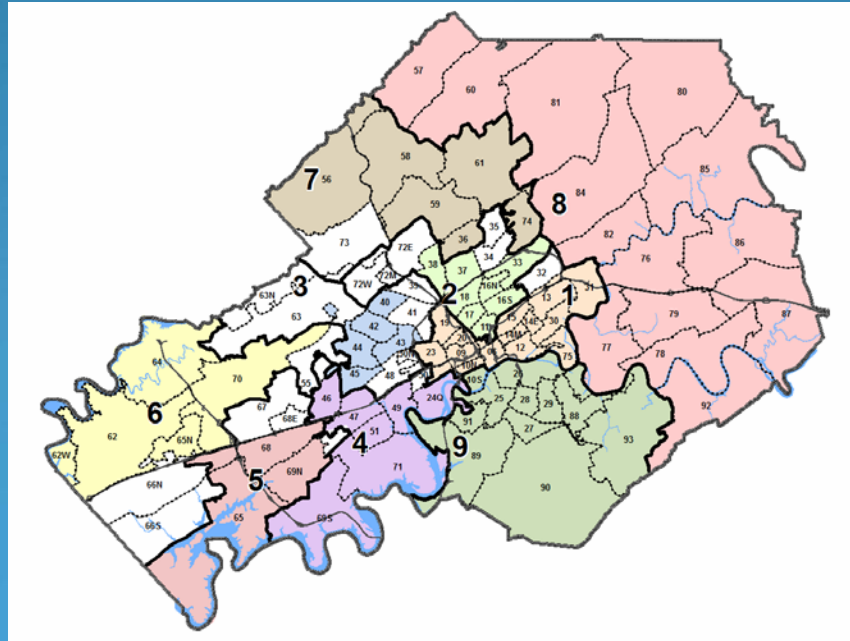

Commission

# “Common Ground”

## Agreement between County Commission Districts and School Board Districts

